



Year 4 Residential Visit
Carreg Adventure, Stouthall

Monday 4th Manor
May -

Thursday 7th May 2020

Residential Visits

Educational visits often provide the most enjoyable experiences and enduring memories from school days.

Residential experiences, in particular, offer unique opportunities to encounter the practical realities of:

living together away from home, family and familiar surroundings. They provide a powerful vehicle for developing self-awareness and social skills



National Curriculum

Key Stage 2 Physical Education

Children should be taught to take part in outdoor and adventurous activity challenges both individually and within a team

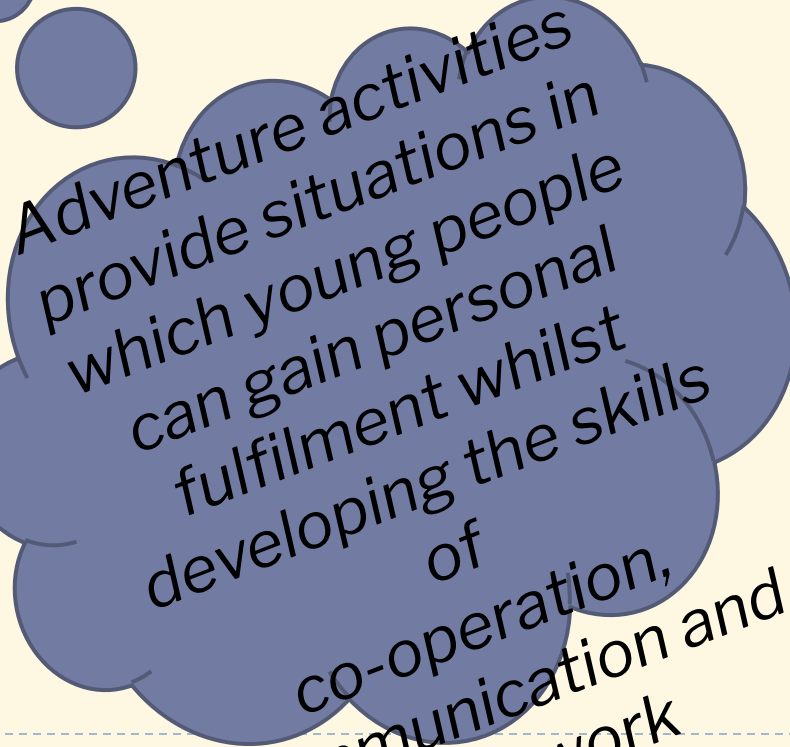

Adventure activities provide situations in which young people can gain personal fulfilment whilst developing the skills of co-operation, communication and teamwork

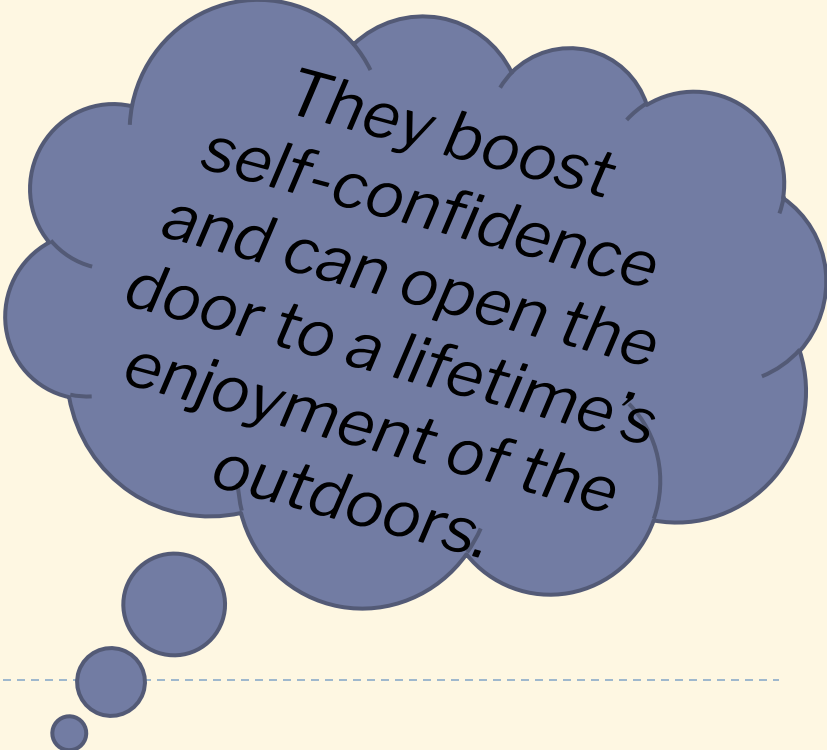

They boost self-confidence and can open the door to a lifetime's enjoyment of the outdoors.

Stouthall Manor, Gower

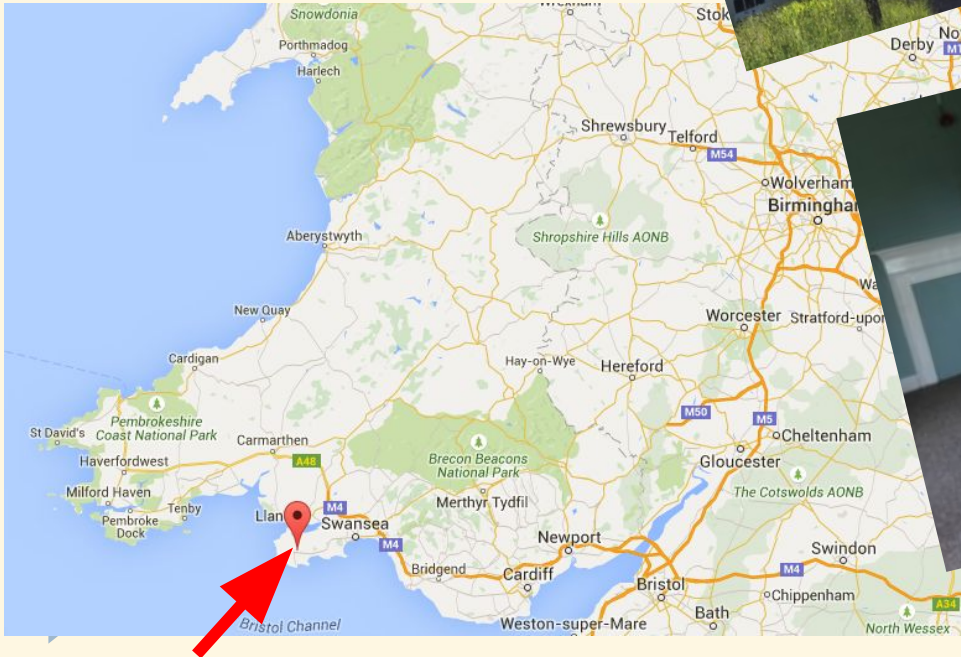
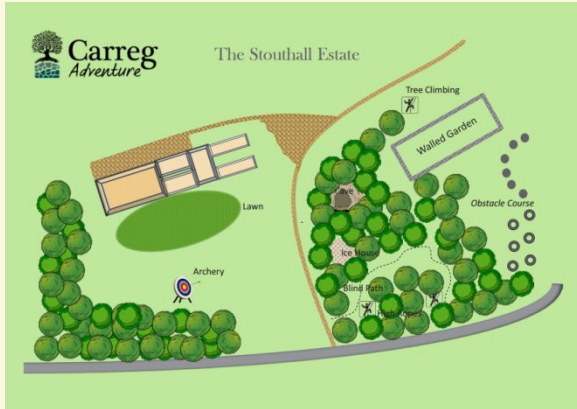







- The private 16 acre Estate has been carefully renovated to retain a feeling of wilderness but with safety and security as a priority. The owners have worked tirelessly to safeguard all the natural advantages of the Estate while providing students with unparalleled access to nature.
- For groups of 40 or more they offer use of the Mansion House accommodation

SAMPLE ADVENTURE / LEARN ENGLISH MENU

BREAKFAST

CHOICE OF CEREALS

SELECTION OF YOGHURTS &
FRUIT

BACON, SAUSAGE & EGG

OR

PASTRIES & PORRIDGE

LUNCH

HOMEMADE SOUP OF THE DAY

FRESH BREAD

HOT OR COLD DELI SELECTION

CHOICE OF FRUITS



Carreg
Adventure

DINNER

FRESH SALAD BAR

SELECTION OF BREADS

VEGETABLE MEDLEY

A selection of hot vegetables including a starch option (e.g. mashed potatoes, rice, pasta, wedges, etc.)

ROASTED CHICKEN BREAST

or Quorn Chicken Fillet (V)

OVEN COOKED BEEF MEATBALLS

or Quorn Meatballs (V)

HOMEMADE BATTERED COD

or Vegetarian Garlic Kiev (V)

BUILD YOUR OWN BURITTO

Selection of meat and vegetarian options

All our menus are adjusted seasonally and specific dietary requirements can be catered for.

First meal will be dinner of the day of arrival. A packed lunch is provided on the day of departure.

Carreg Adventure

- Archery
- Ships ladder
- Arthur's Stone Hike
- Woodland obstacle course
- Campfire
- Crate Stack
- Orienteering
- Buggy Building
- Tree Climbing
- Evening Quiz
- Water Balloon drop



Hiking



Tree Climbing

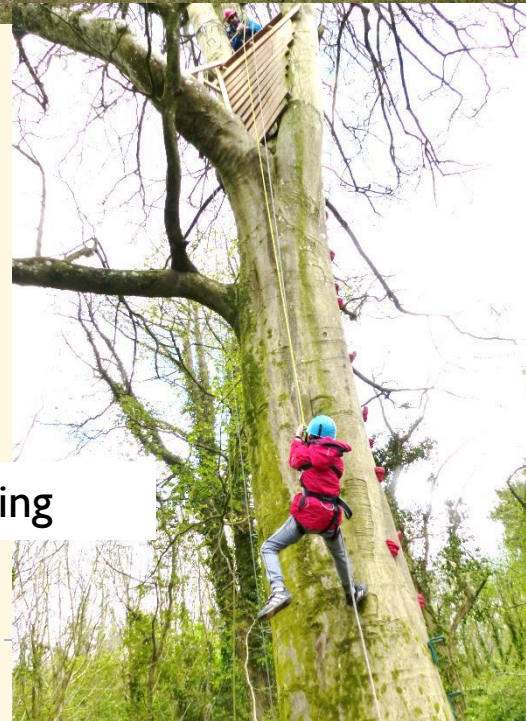



Archery



Camp Fire

-
- *5 activities per day lead by qualified instructors*
 - *Accommodation in Manor House & access to 16 acre grounds*
 - *Exclusive use of site if over 40 children*
 - *Coach Travel*

□ **£230-250 (depending on final numbers)**



Frequently asked questions:

- My child has never stayed away from home before and I'm a little worried about it/ my child is a little worried about it so should they go on the residential?
- My child has particular needs or medical conditions so will they be able to go on the trip and have their needs met?
- I'm not sure I would be able to pay the full amount in one go?
- If my child is worried about some of the activities do they have to do them?



- What are the sleeping arrangements?

- Will I be able to contact my child?
- I'm not sure I would be able to pay the full amount in one go?
- If my child is worried about some of the activities do they have to do them?





What next?

A letter will be sent out via ParentMail. There will be a an option which asks you to indicate whether you would like your child to go on the residential. The price will depend on the number of children and we will be asking for a deposit of £50.00 to secure your child's place.

All payment and permission must be made online via ParentMail. We do not want individual financial situations to stop any child from taking part in the residential, so please do come and speak to myself or Lisa Francis should this be the case.

